

| REF | DESCRIPTION | MATERIAL | CODE |
|-----|---|-----------------------|------|
| 10 | Containment shell | SS 316L | |
| 20 | Ext. Magnet | CoSm/ Carbon Steel | |
| 30 | Int. Magnet | SS 316L/CoSm | |
| 40 | Impeller | SS 316L | |
| 50 | Set O-Rings (a+b+c) a + b = O-Ring 4300 (234) c = O-Ring 4362 (239) | VITON | |
| 61 | Thrust Bearings | PCarbon | |
| 62 | Rear Ring | SS316L | |
| 70 | Shaft | SIC | |
| 75 | Sleeve Bearings Bearings (d+e) Bearing (f) | PCarbon SS316 | |
| 78 | Bracket Nema 145TC | CAST IRON | |
| 79 | Rub Ring | Bronze | |
| 84 | End Cover | SS 316L | |
| 85 | Pump Casing | SS 316L | |
| 88 | Rear Wet End (10+30+40+50+61+62+70+75) | / | |
| 90 | Wet End (10+30+40+50+61+62+70+75+84+85) | / | |

(xx) DIFFERENT FROM MOTOR MANUFACTURER
- DIRECTION AND PORTS LOCATION ARE REVERSIBLE

FLANGES ANSI 150#

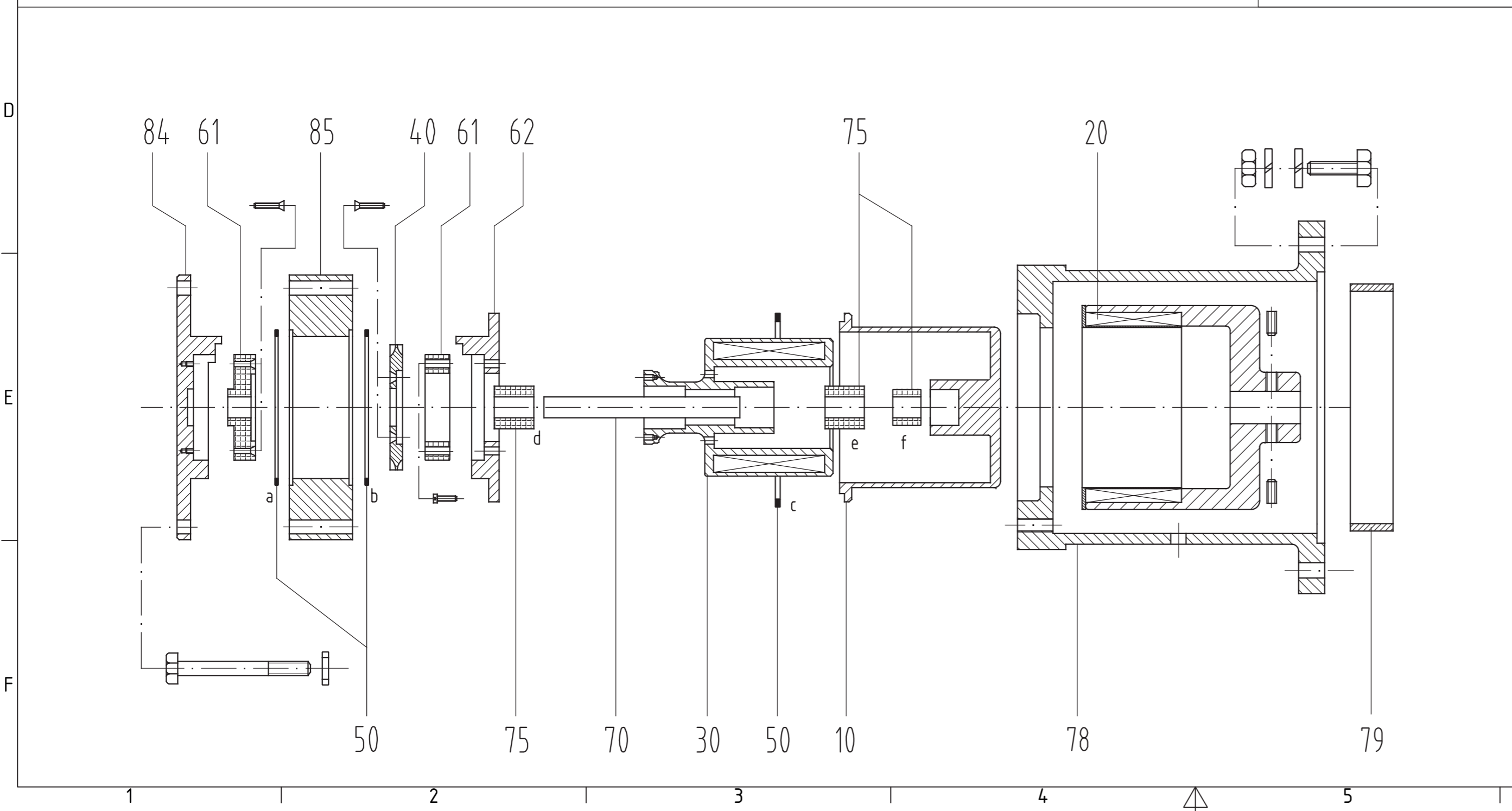

Alle Angaben unverbindlich, technische Änderungen vorbehalten! Technical data not binding and subject to change!
Copyright MARCH PUMPEN GmbH & Co.KG 2023

| | | | | |
|--------|--|------------------------|---|------|
| | MARCH PUMPEN GmbH & Co.KG Rätthausstraße 2 D-35394 Gießen info@march-pumpen.com www.march-pumpen.com | | Allgemeintoleranzen nach DIN ISO 2768-m | |
| | | | Alle Kanten gratfrei | |
| | | Datum | Name | |
| | | Gezeichnet | 31.05.2023 | Lach |
| | | Kontrolliert | | |
| | | Norm | | |
| | | Series MTA | | |
| | | MTA37 F ANSI NEMA145TC | | |
| | | DPCA-MTA-0037-ANSI | | |
| | | | | 1 |
| | | | | A2 |
| Status | Änderungen | Datum | Name | |